

3000 Easy Steps

Large Scale Data Integration and
Stewardship

Texas GIS Forum

October 2024

CoreLogic



What are Parcels ?

CoreLogic





Parcels
are **legal**
instruments
referencing real
features to make
land ownership
transferable

CoreLogic

- Native lands
- Land taken by settlers / US gov't

Native American Loss of Land

Due to settler colonialism and ethnic cleansing

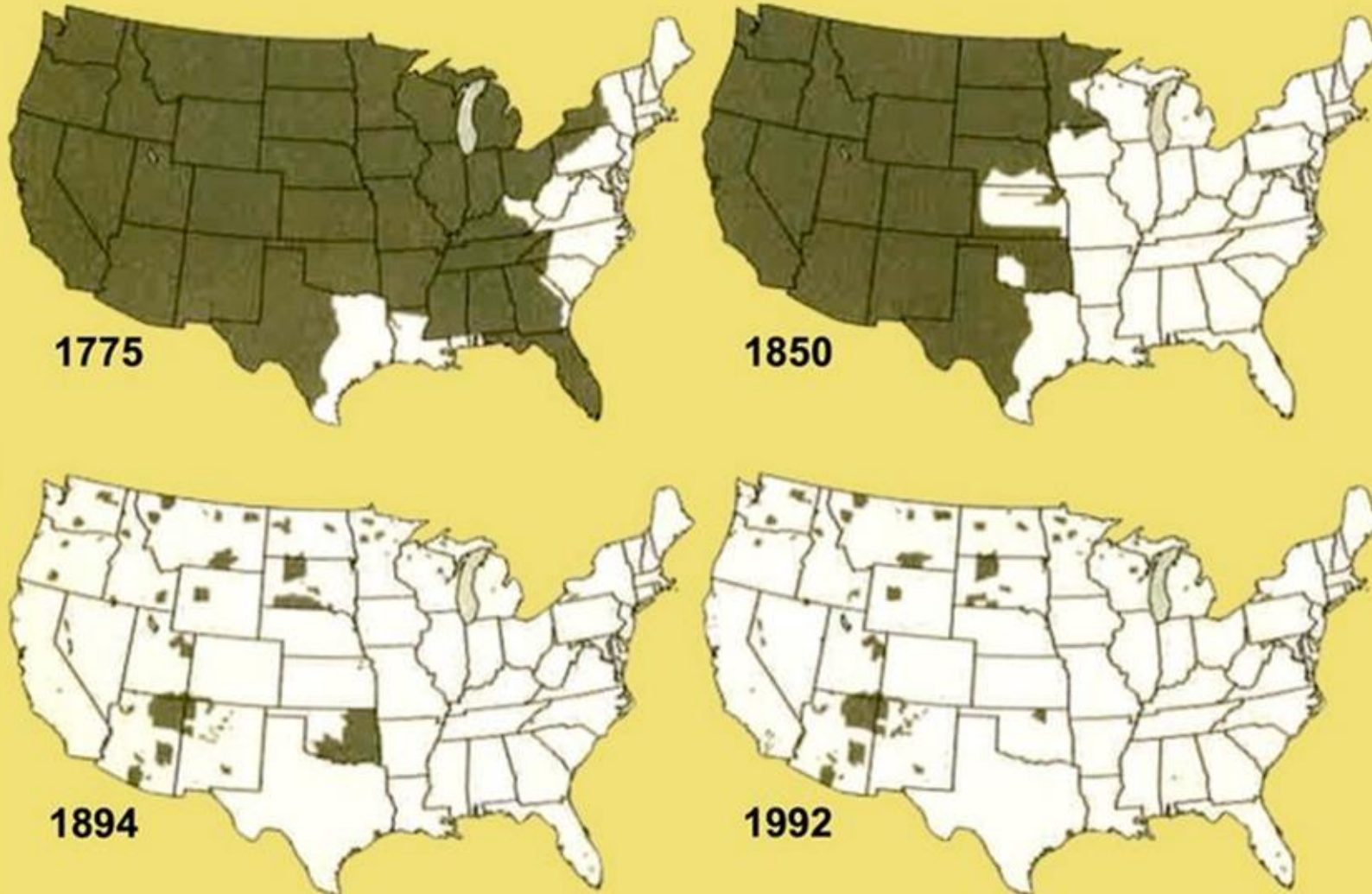

Behold, A Parcel

BEGINNING at an iron rod set in the North line of the SW/4 of the NE/4 of Section 32 for the NE corner of this tract, from which the NE corner of the SW/4 of the NE/4 of Section 32, Block 26, T&P Rwy Co. Surveys, Mitchell County, Texas, bears N. 77 degrees 00'05"E 471.04 ft.;

THENCE S. 13 degrees 02'55" E 580.68 ft. to a point in concrete around a 4" iron pipe post for the SE corner of this tract, from which the center of said 4" pipe post bears S 75 degrees 25'46" W 0.66 ft.;

THENCE S 76 degrees 49'00" W 640.44 ft. to a 1-1/4" Brass Cap in concrete for the SW corner of this tract;

THENCE N. 13 degrees 00'00" W 582.74 ft. to a 1-1/4" Brass Cap in concrete and being in the North line of the SW/4 of the NE/4 of Section 32 for the NW corner of this tract;

THENCE N. 77 degrees 00'05" E with the North line of the SW/4 of the NE/4 of Section 32, 639.9 ft. to the place of beginning, containing 8.549 acres of land, more or less.

Precise, legally enforceable, but inconvenient for visualization and analysis



BEGINNING at an iron rod set in the North line of the SW/4 of the NE/4 of Section 32 for the NE corner of this tract, from which the NE corner of the SW/4 of the NE/4 of Section 32, Block 26, T&P Rwy Co. Surveys, Mitchell County, Texas, bears N. 77 degrees 00'05"E 471.04 ft.;

THENCE S. 13 degrees 02'55" E 580.68 ft. to a point in concrete around a 4" iron pipe post for the SE corner of this tract, from which the center of said 4" pipe post bears S 75 degrees 25'46" W 0.66 ft.;

THENCE S 76 degrees 49'00" W 640.44 ft. to a 1-1/4" Brass Cap in concrete for the SW corner of this tract;

THENCE N. 13 degrees 00'00" W 582.74 ft. to a 1-1/4" Brass Cap in concrete and being in the North line of the SW/4 of the NE/4 of Section 32 for the NW corner of this tract;

THENCE N. 77 degrees 00'05" E with the North line of the SW/4 of the NE/4 of Section 32, 639.9 ft. to the place of beginning, containing 8.549 acres of land, more or less.

THENCE... I am lost

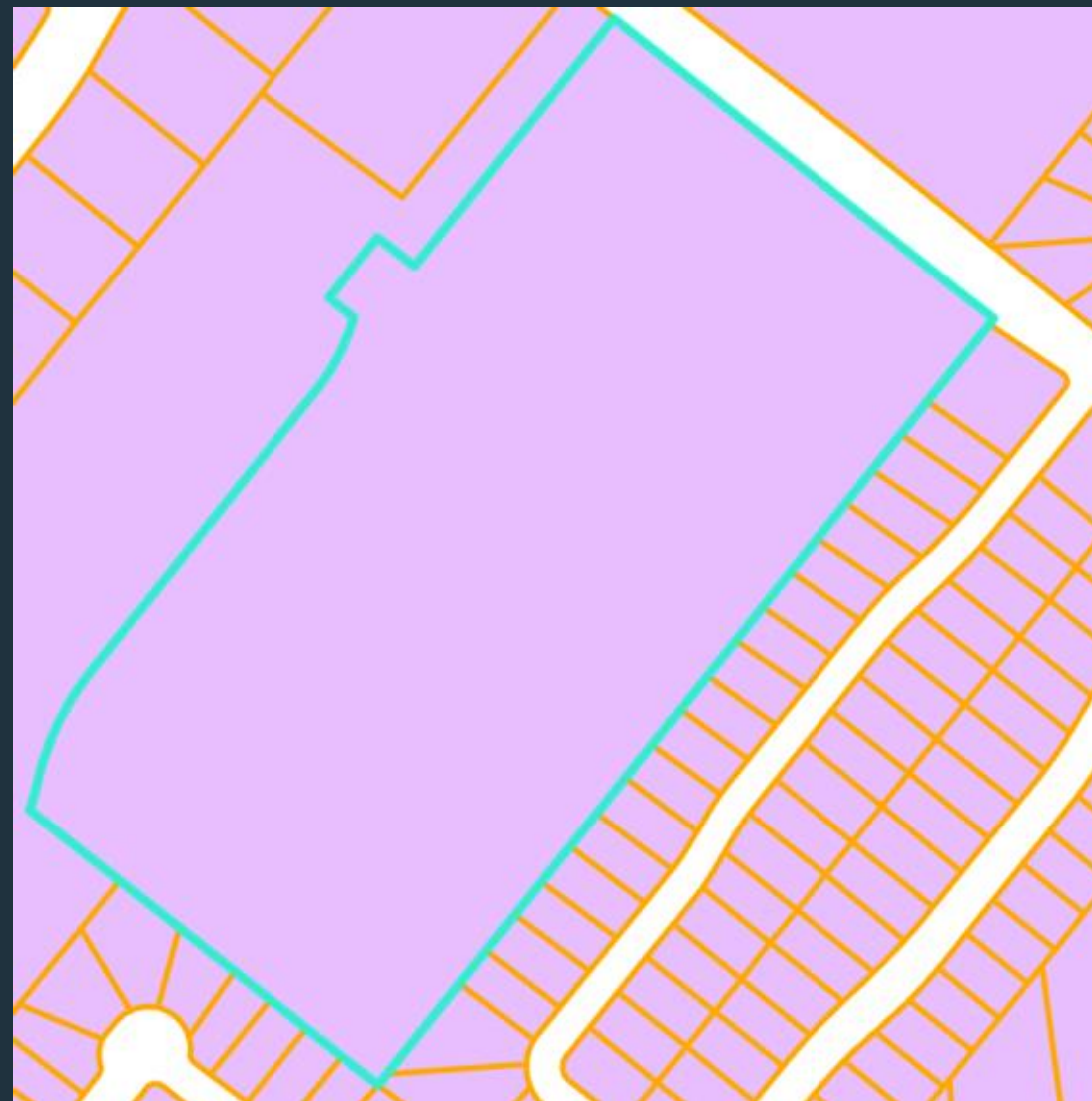

A picture is worth a thousand THENCES



The Challenges of Herding 3,244 ~~Cats~~ Counties

CoreLogic

PIN	SITUS	MAILING	OWNER	PRV_PIN
------------	--------------	----------------	--------------	----------------

APN	SUB	BLOCK	LOT	FULL_ADDR
------------	------------	--------------	------------	------------------

NAME	ASSR_NUM	DIR	NUM	STREET
-------------	-----------------	------------	------------	---------------

PARCELNO	OWNNAME	HOUSENUM	STREET	UNIT
-----------------	----------------	-----------------	---------------	-------------

BOOK	PAGE	LOT	OWN1_LN	OWN1_FN
-------------	-------------	------------	----------------	----------------

PIN	SITUS	MAILING	OWNER	PRV_PIN
-----	-------	---------	-------	---------

APN	SUB	BLOCK	LOT	ADDRESS
-----	-----	-------	-----	---------

NAME	ASSR_NUM	DIR	NUM	STREET
------	----------	-----	-----	--------

PARCELNO	OWNNAME	HOUSENUM	STREET	UNIT
----------	---------	----------	--------	------

BOOK	PAGE	LOT	OWN1_LN	OWN1_FN
------	------	-----	---------	---------

PIN	SITUS	MAILING	OWNER	PRV_PIN
-----	-------	---------	-------	---------

APN	SUB	BLOCK	LOT	FULL_ADDR
-----	-----	-------	-----	-----------

NAME	ASSR_NUM	DIR	NUM	STREET
------	----------	-----	-----	--------

PARCELNO	OWNNAME	HOUSENUM	STREET	UNIT
----------	---------	----------	--------	------

BOOK	PAGE	LOT	OWN1_LN	OWN1_FN
------	------	-----	---------	---------

PIN	SITUS	MAILING	OWNER	PRV_PIN
------------	--------------	----------------	--------------	----------------

APN	SUB	BLOCK	LOT	FULL_ADDR
------------	------------	--------------	------------	------------------

NAME	ASSR_NUM	DIR	NUM	STREET
-------------	-----------------	------------	------------	---------------

PARCELNO	OWNNAME	HOUSENUM	STREET	UNIT
-----------------	----------------	-----------------	---------------	-------------

BOOK	PAGE	LOT	OWN1_LN	OWN1_FN
-------------	-------------	------------	----------------	----------------

PIN	SITUS	MAILING	OWNER	PRV_PIN
-----	-------	---------	-------	---------

APN	SUB	BLOCK	LOT	FULL_ADDR
-----	-----	-------	-----	-----------

NAME	ASSR_NUM	DIR	NUM	STREET
------	----------	-----	-----	--------

PARCELNO	OWNNAME	HOUSENUM	STREET	UNIT
----------	---------	----------	--------	------

BOOK	PAGE	LOT	OWN1_LN	OWN1_FN
------	------	-----	---------	---------

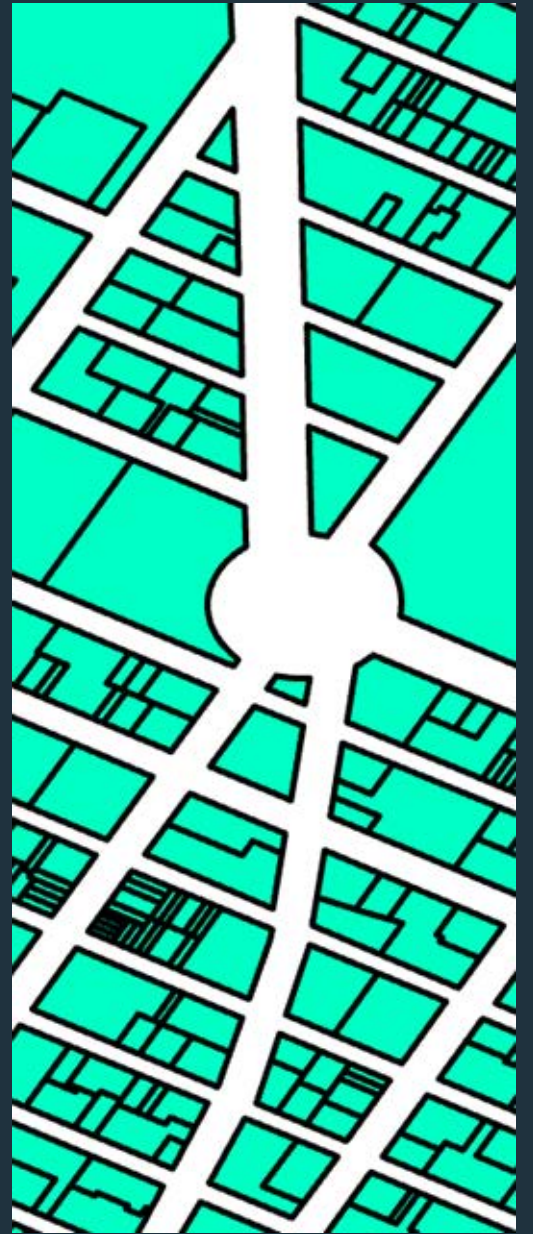
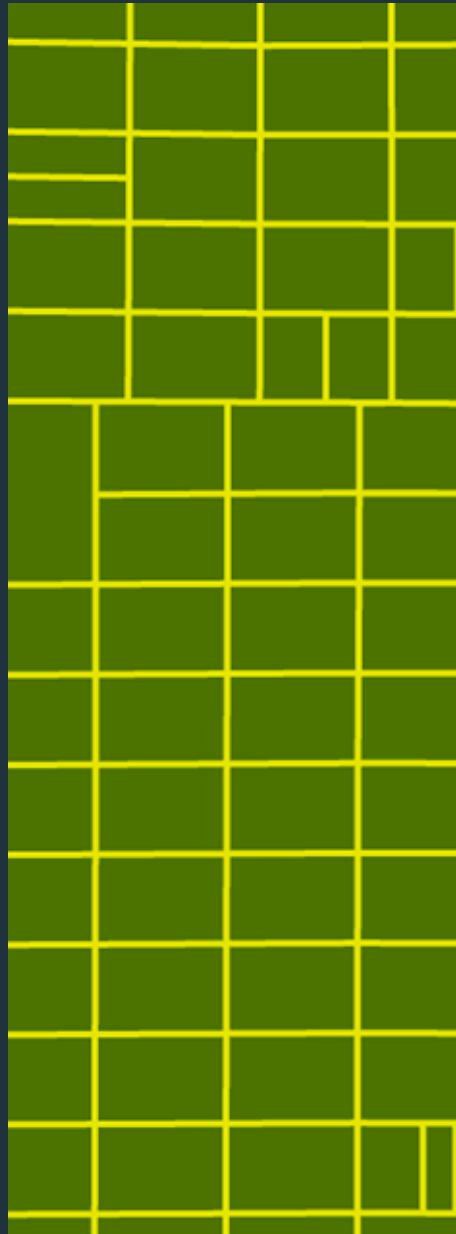

by legal lot

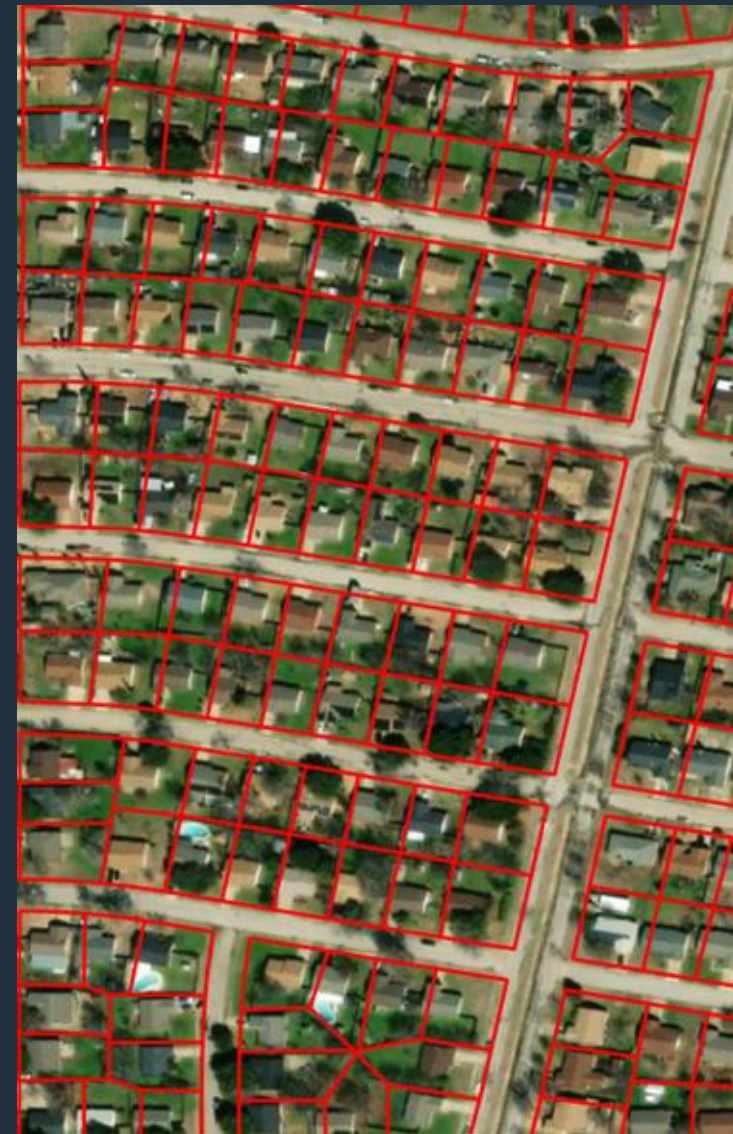

by owner parcel



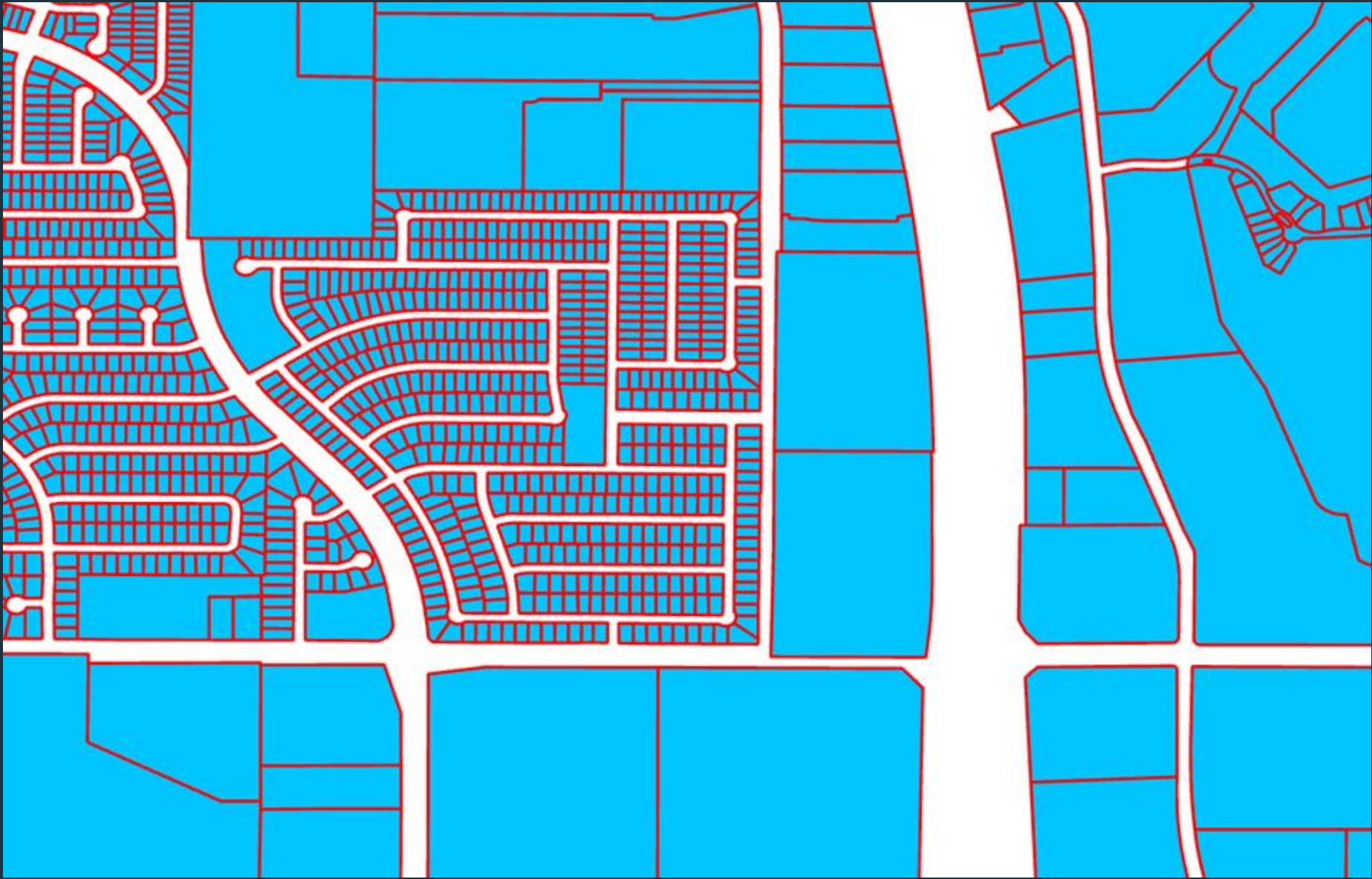

*A Word About
Management*



1:1,447 | 117.3134212°W 33.1312443°N | Selected Features: 624

parcel_06073

Field: Selection: Highlighted:

	PARCEL_ID	STATE_CODE	CNTY_CODE	APN	APN2	ADDR	CITY	STATE	ZIP	PLUS	STD_ADDR	STD_CITY
1	1661717494	06	073	2116911301	211-691-13-01	5500 GRAND PACIFIC DR	CARLSBAD	CA	92008	<Null>	<Null>	<Null>
2	1661856765	06	073	2116911302	211-691-13-02	5500 GRAND PACIFIC DR	CARLSBAD	CA	92008	<Null>	<Null>	<Null>
3	1662290614	06	073	2116911303	211-691-13-03	5500 GRAND PACIFIC DR	CARLSBAD	CA	92008	<Null>	<Null>	<Null>
4	1661767168	06	073	2116911304	211-691-13-04	5500 GRAND PACIFIC DR	CARLSBAD	CA	92008	<Null>	<Null>	<Null>
5	1661863802	06	073	2116911305	211-691-13-05	5500 GRAND PACIFIC DR	CARLSBAD	CA	92008	<Null>	<Null>	<Null>
6	1661695775	06	073	2116911306	211-691-13-06	5500 GRAND PACIFIC DR	CARLSBAD	CA	92008	<Null>	<Null>	<Null>
7	1661889401	06	073	2116911307	211-691-13-07	5500 GRAND PACIFIC DR	CARLSBAD	CA	92008	<Null>	<Null>	<Null>
8	1661898276	06	073	2116911308	211-691-13-08	5500 GRAND PACIFIC DR	CARLSBAD	CA	92008	<Null>	<Null>	<Null>
9	1661890999	06	073	2116911309	211-691-13-09	5500 GRAND PACIFIC DR	CARLSBAD	CA	92008	<Null>	<Null>	<Null>

624 of 1,114,585 selected | Filters: 100%





a bit TOO smug...







This is How **We** Do It

CoreLogic

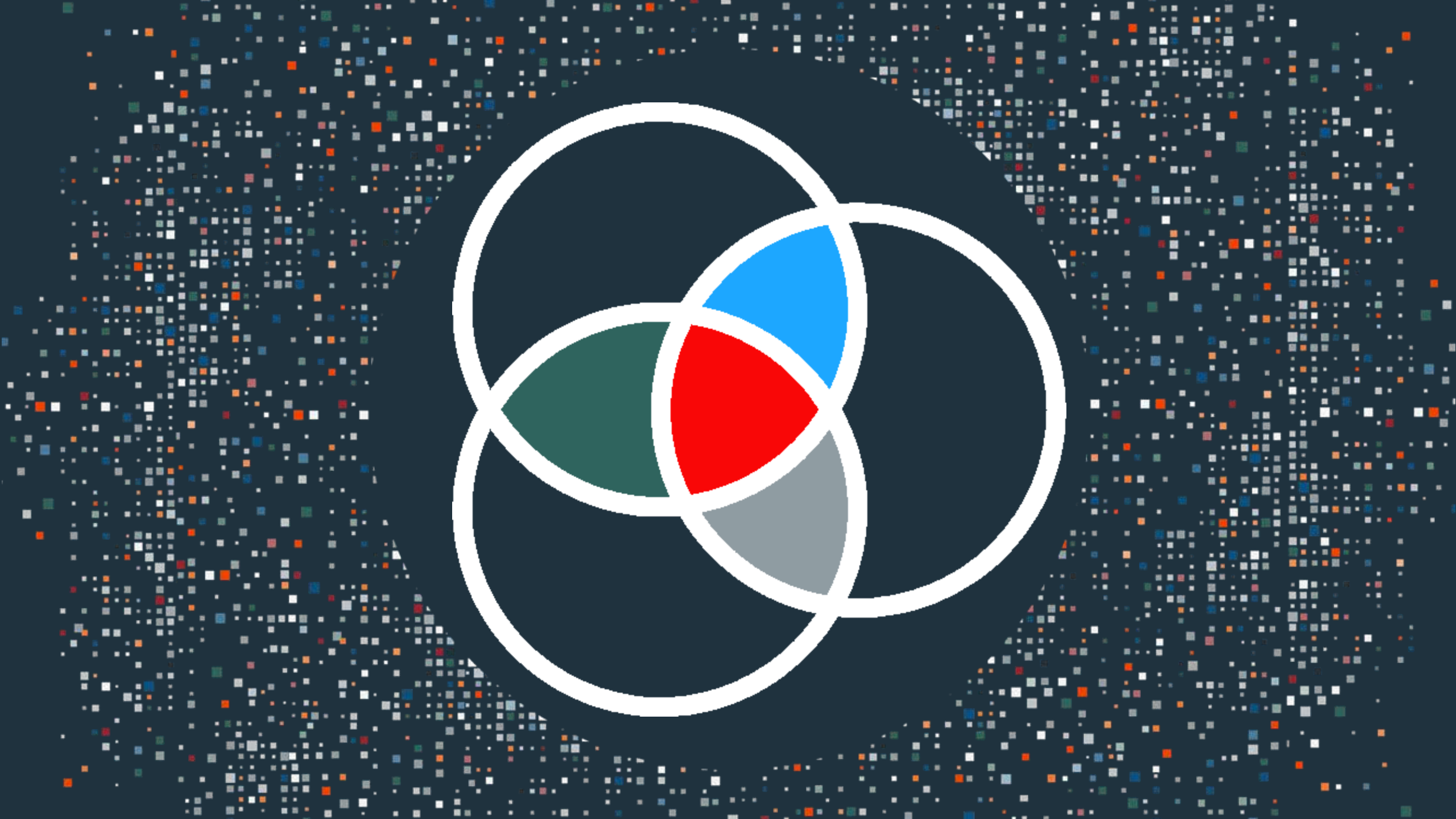

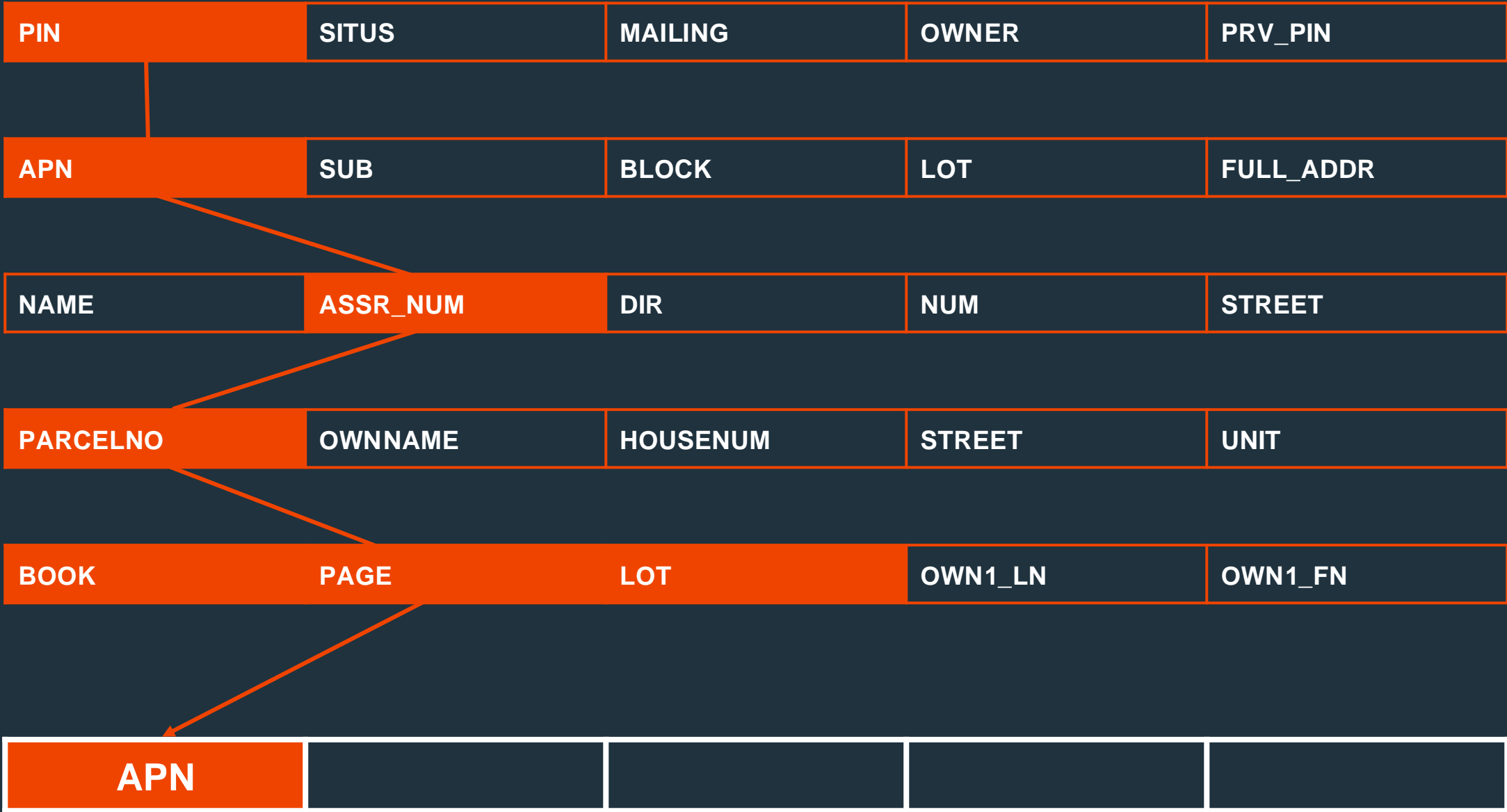

PIN	SITUS	MAILING	OWNER	PRV_PIN
-----	-------	---------	-------	---------

APN	SUB	BLOCK	LOT	FULL_ADDR
-----	-----	-------	-----	-----------

NAME	ASSR_NUM	DIR	NUM	STREET
------	----------	-----	-----	--------

PARCELNO	OWNNAME	HOUSENUM	STREET	UNIT
----------	---------	----------	--------	------

BOOK	PAGE	LOT	OWN1_LN	OWN1_FN
------	------	-----	---------	---------

APN	APN2			
-----	------	--	--	--

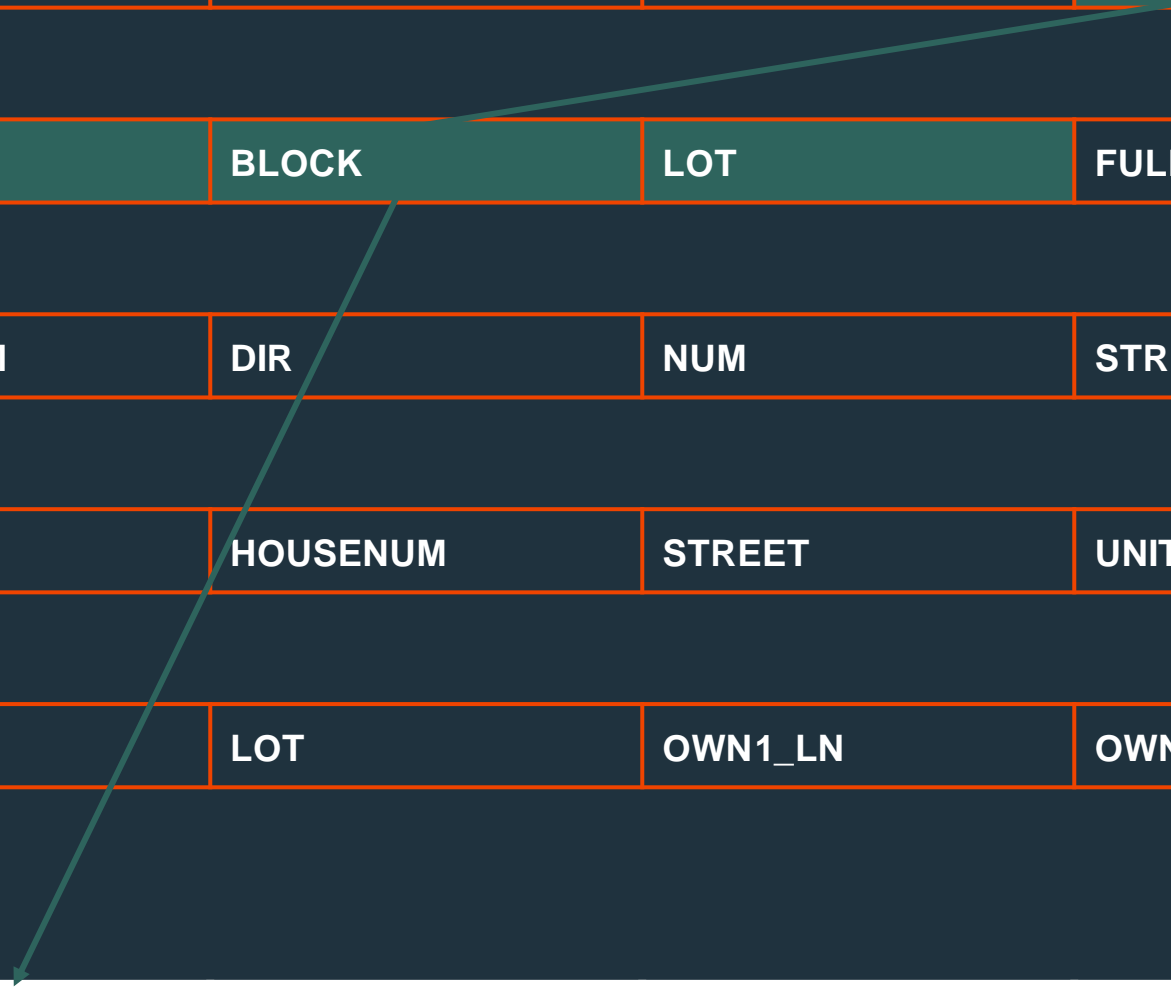

PIN	SITUS	MAILING	OWNER	PRV_PIN
-----	-------	---------	-------	---------

APN	SUB	BLOCK	LOT	FULL_ADDR
-----	-----	-------	-----	-----------

NAME	ASSR_NUM	DIR	NUM	STREET
------	----------	-----	-----	--------

PARCELNO	OWNNAME	HOUSENUM	STREET	UNIT
----------	---------	----------	--------	------

BOOK	PAGE	LOT	OWN1_LN	OWN1_FN
------	------	-----	---------	---------

APN	APN2	SITUS		
-----	------	-------	--	--

12629 + Redbud Trail

8109 + W + Heatherglen + St

16238 + Tanglewood + Way + Apt 26C

526 W + 300 S

12629 Redbud Trail Buda TX 78610

8109 W Heatherglen St Springfield

RES 16238 Tanglewood Way Apt 26C

000526 W 00300 S



In County GIS We Trust



State Plane Coordinate System

Rick King compiled and organized the information on this page, long hosted at the now defunct home.comcast.net/~rickking04/gis/spc.htm. A quick Google search shows almost 400 links to that page from across the geospatial community, from universities to professionals to students. Upon finding that it had vanished, I contacted Rick, and he has graciously allowed me to maintain it for those in need of this very useful information.

In 2018, [GeoHipster](#) did an [interview](#) with Rick and [me](#). Please direct all inquiries [here](#).



DOWNLOADS

[Github](#) | [Excel](#) | [Map](#) | [Metadata](#)

stateplane.org



3 m

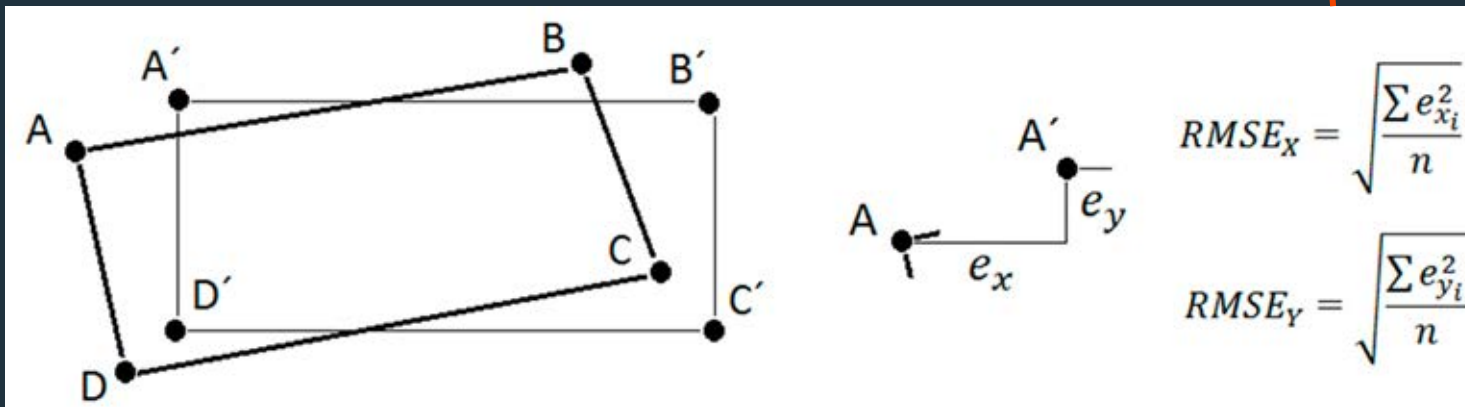

(math not to scale)



A Word About

Montana



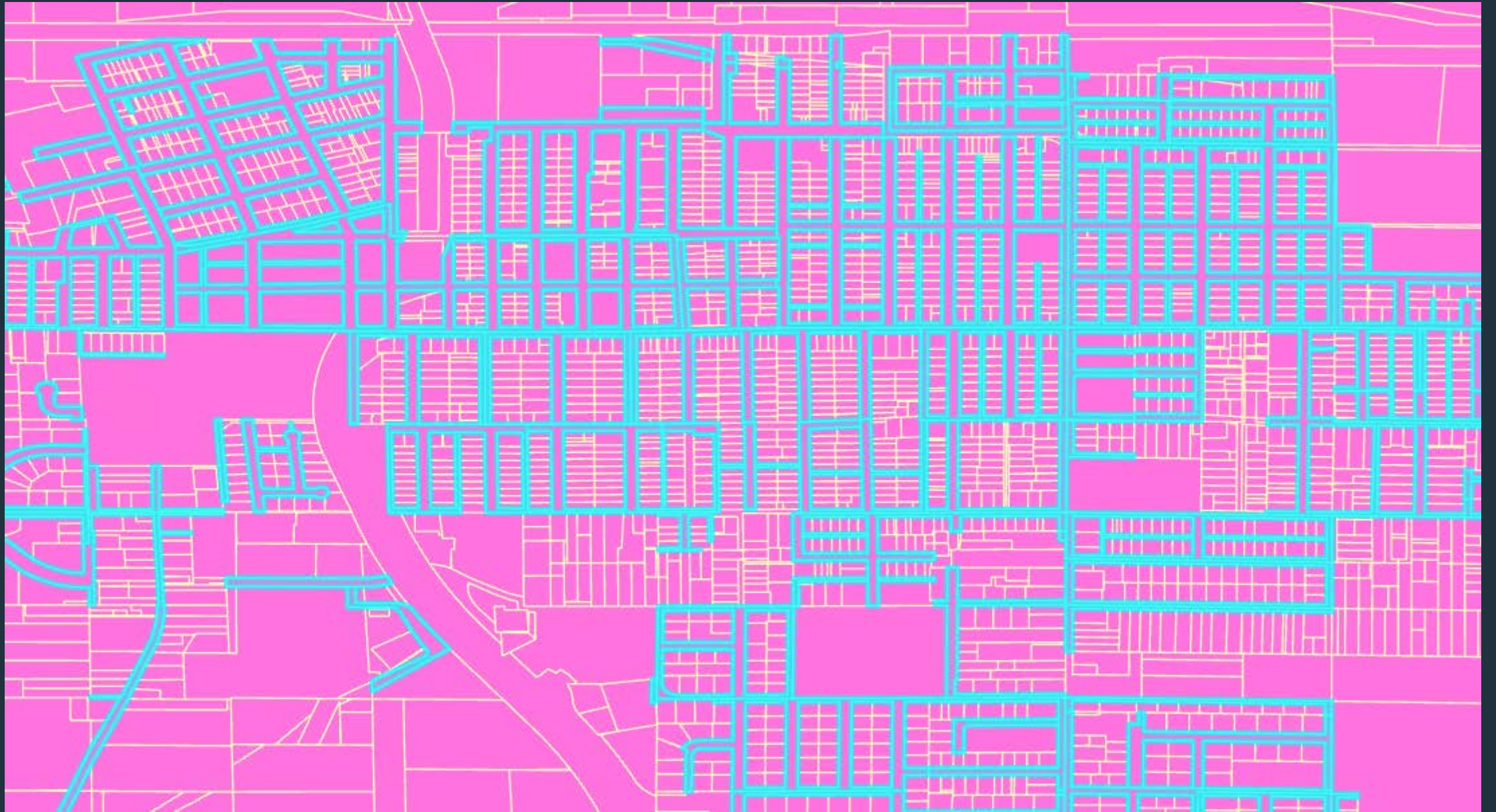

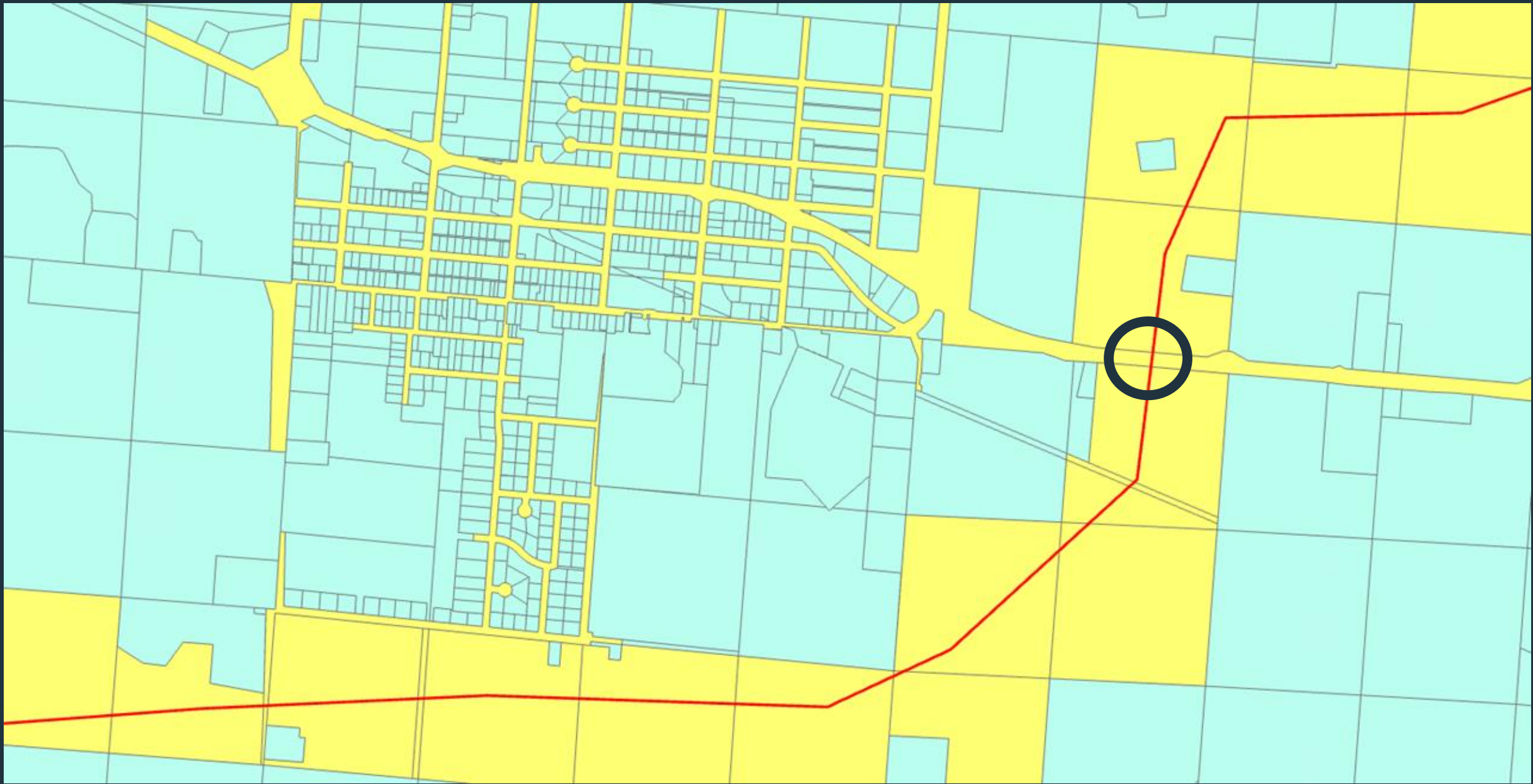



The Parcels Must Flow

CoreLogic





ParcelPoint® Quarterly Release 2024.2
5/15/2024

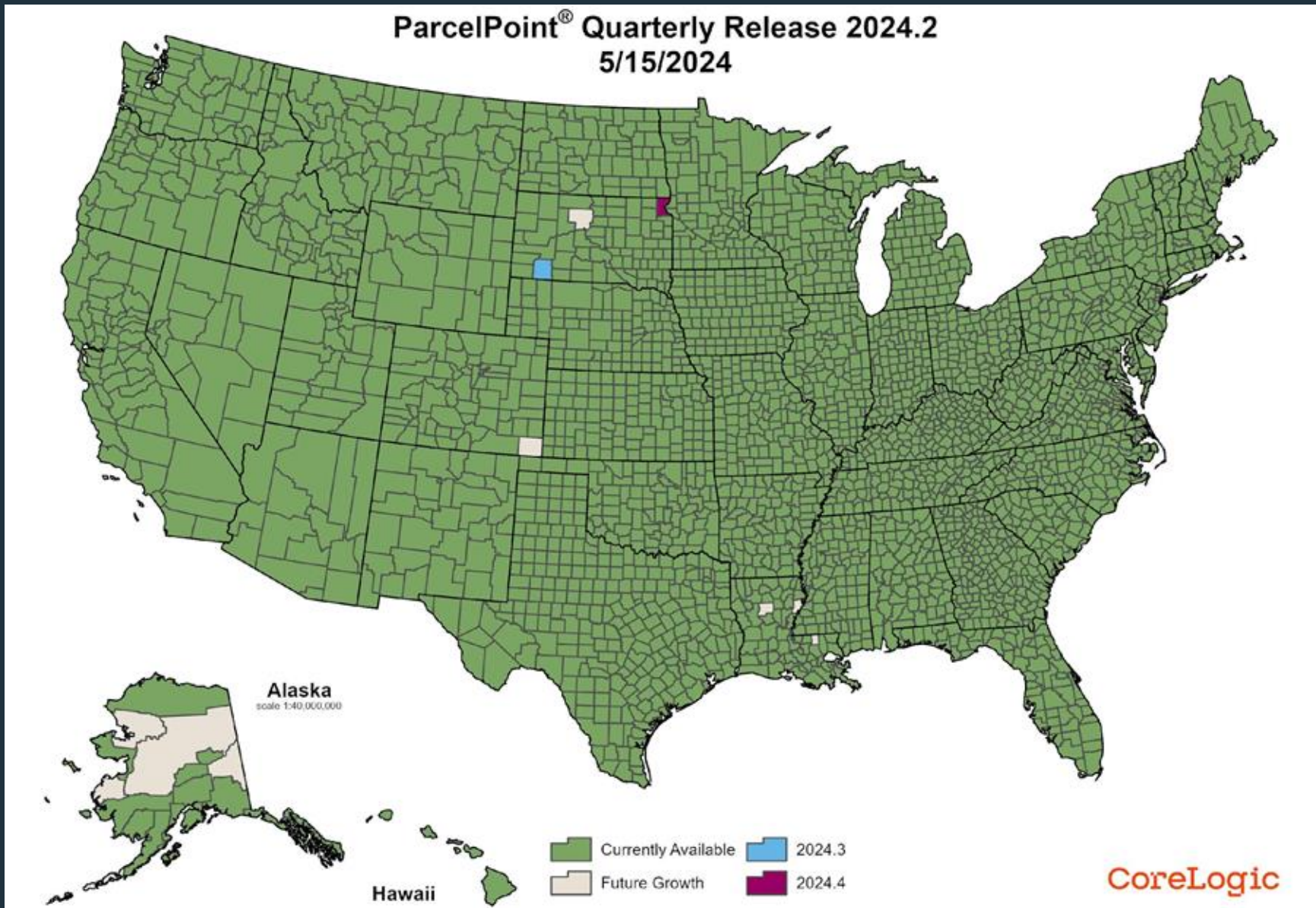

parcel data is brat [?]



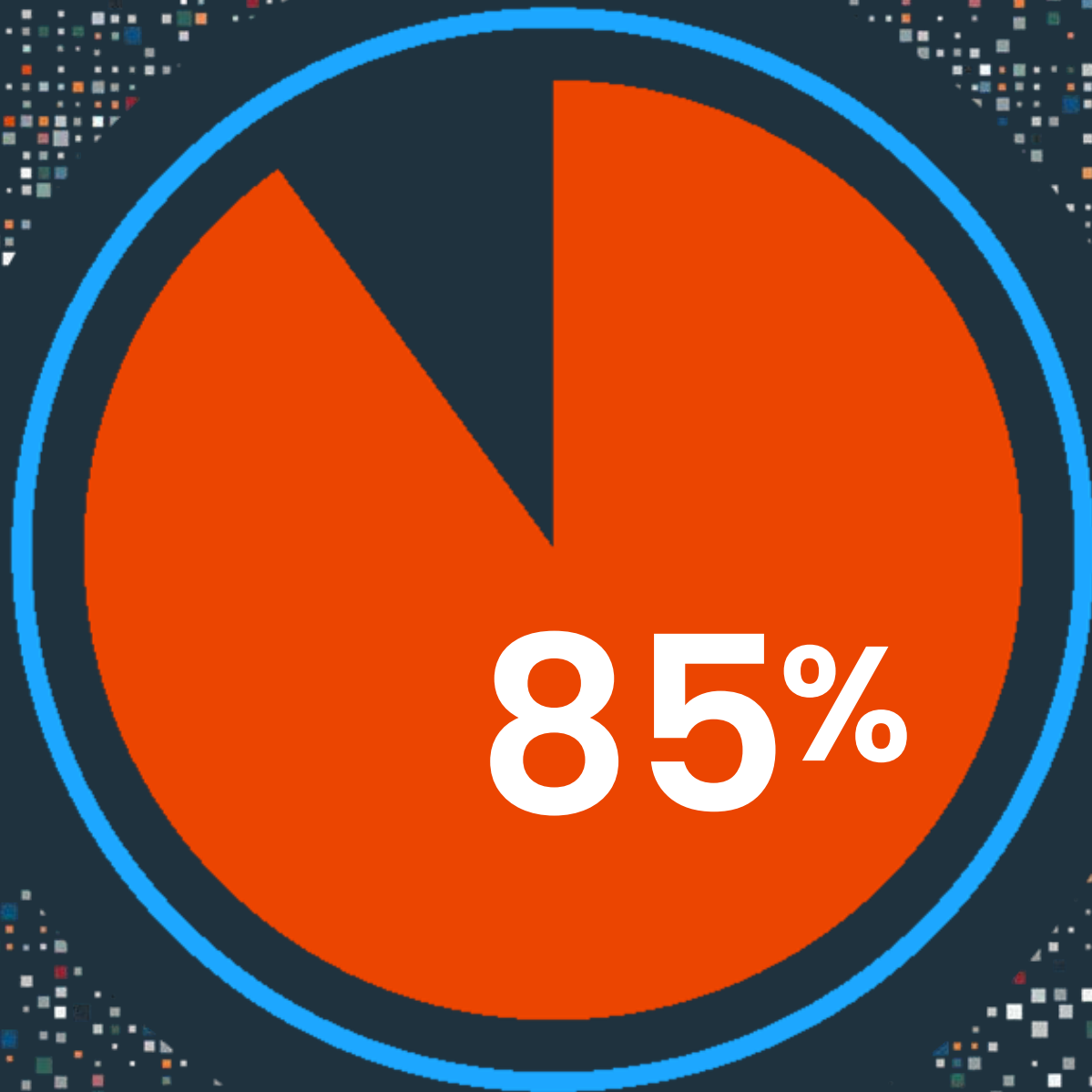



REVISION ID
75633
62554
49563
41258

REVISION ID
78231
71562
63547
56875
49562

REVISION ID
76945
70222
64287
52236
45341
36758

REVISION ID
80362
36954



SHP

DBF

SHX

PRJ



LICENSING

ATTRIBUTION

COVERAGE

FEATURE COUNT

ATTRIBUTES

A Word About

Metadata



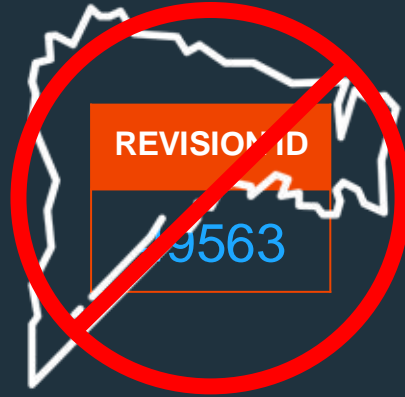
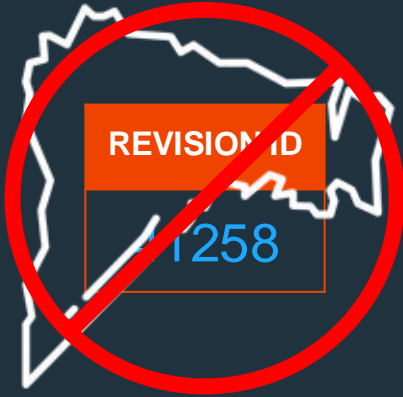

FEATURES
32,269
NSSDA
10 m

FEATURES
33,654
NSSDA
10 m

FEATURES
33,441
NSSDA
8 m

FEATURES
35,113
NSSDA
8 m



The Long Game

CoreLogic

How It Started



How It's Going



APN	APN2	SITUS	SUB	ZONING
-----	------	-------	-----	--------

APN	APN2	SITUS	TWP	DISTRICT
-----	------	-------	-----	----------

APN	APN2	SITUS	WTRSHD	EXEMPT
-----	------	-------	--------	--------

APN	APN2	SITUS	OWNER	LAST_SALE
45897-B-02	M4986	326 PECAN ST	WAKEM	126300

APN	APN2	SITUS	OWNER	LAST_SALE
45897-B-02	M4986	326 PECAN ST	RIVERA	216500

APN	APN2	SITUS	OWNER	LAST_SALE
45897-B-02	M4986	326 PECAN ST	AU	365000

APN	APN2	SITUS	OWNER	LAST_SALE
45897-B-02	M4986	326 PECAN ST	CLAYTON	292000



&





<p>REVISION ID 2554</p>	<p>REVISION ID 73633</p>
<p>FEATURES 33,441</p>	<p>FEATURES 35,113</p>
<p>NSSDA 8 m</p>	<p>NSSDA 8 m</p>

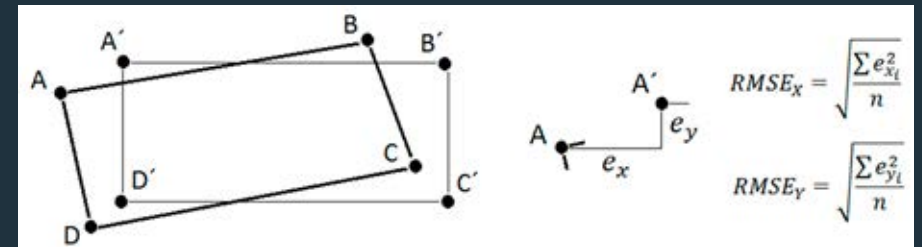

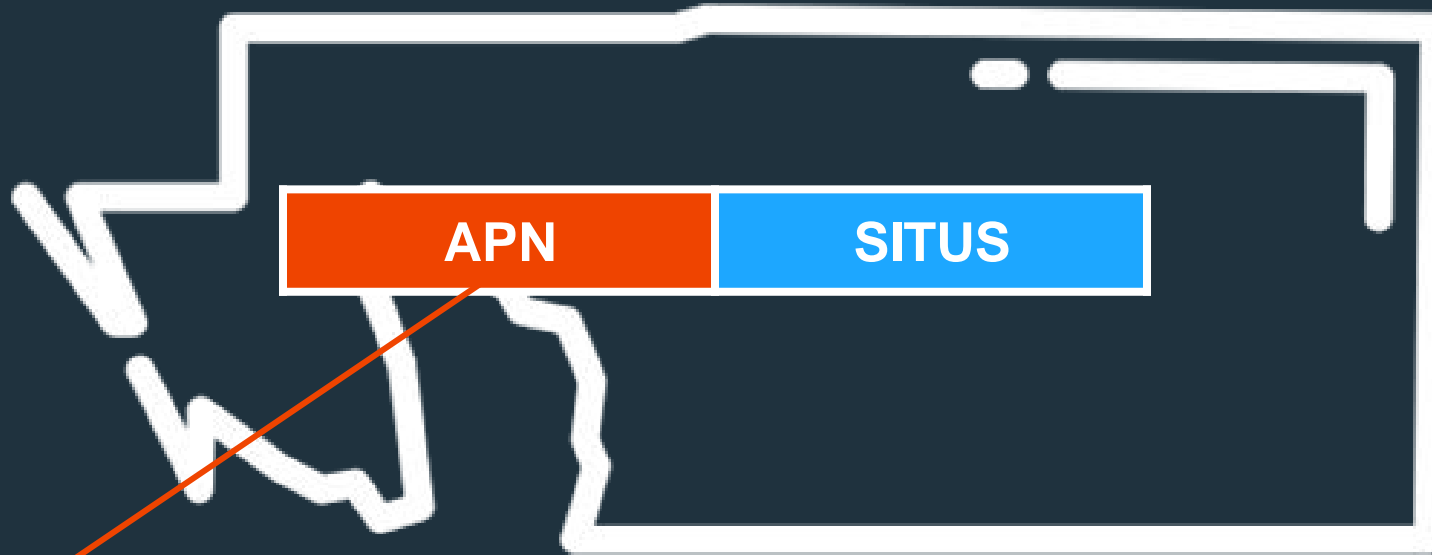

etc. is short for "200+ attributes"



REVISION ID	YEAR
76945	2024
70222	2023
64287	2021
52236	2018
45341	2014
36758	2009

better, faster, stronger

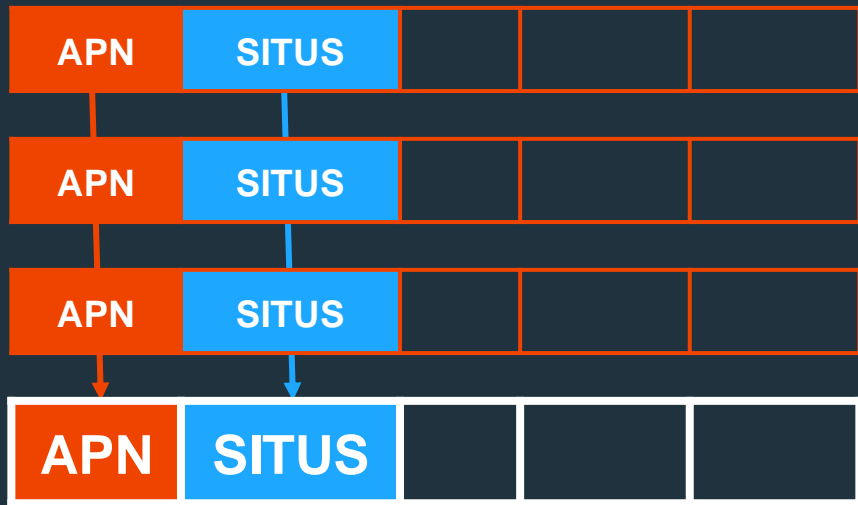
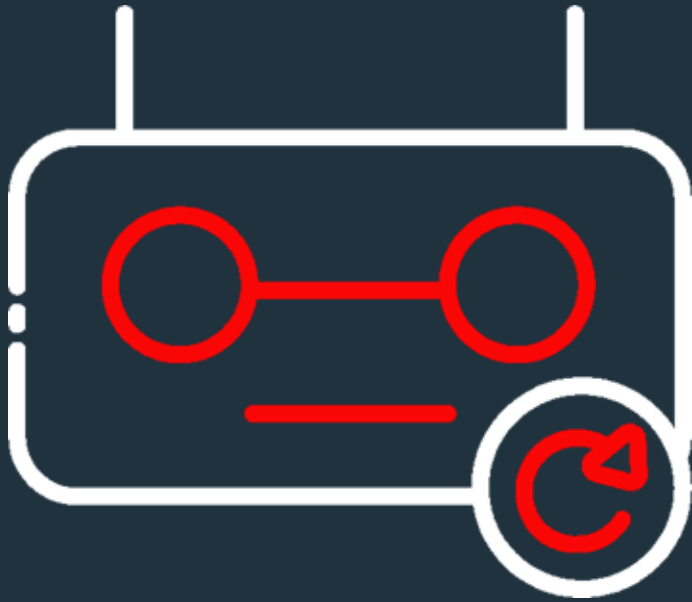

our work is never over



3000 Easy Steps

Large Scale Data Integration and
Stewardship

Texas GIS Forum

October 2024

CoreLogic

Data Acquisition

Brenda Koch | Richard Ricks | Cindy Hart | Angie Chua | Celeste Little | Mara Gomez | Ping Galimba

GIS

Andy Strawn | Ryan Murphey | Gilbert Ramon | Patrick Mason | Mason Gedanken | Timmy Szpakowski
Francisco Padilla | Janis Holliman | Tatjana Zivkovic | Richard Gainey | Darrin Speer

Managers

Mark Dorsey | Kate Wilhelm | Nydia Pacheco

Russell Taylor
rutaylor@corelogic.com
ret3.net
stateplane.org



CoreLogic

Illustration Sources

no gifts by verry poernomo from [Noun Project](#) (CC BY 3.0)
Native American Loss of Land from [UKMR](#)
confusion by Toli from [Noun Project](#) (CC BY 3.0)
human brain by Atif Arshad from [Noun Project](#) (CC BY 3.0)
Venn Diagram by Nurfajri Aldi from [Noun Project](#) (CC BY 3.0)
authority by kensocan from [Noun Project](#) (CC BY 3.0)
stateplane.org by Russell Taylor from [stateplane.org](#)
resource mapping by Wagiman from [Noun Project](#) (CC BY 3.0)
scales by Aidan Stonehouse from [Noun Project](#) (CC BY 3.0)
Mortgage by supalerk laipawat from [Noun Project](#) (CC BY 3.0)
NSSDA Graphic by Ruiz-Lendínez, Juan José, Francisco Javier Ariza-López, and Manuel Antonio Ureña-Cámara. 2019. "Study of NSSDA Variability by Means of Automatic Positional Accuracy Assessment Methods" ISPRS International Journal of Geo-Information 8, no. 12: 552. <https://doi.org/10.3390/ijgi8120552>
Share by Gregor Cresnar from [Noun Project](#) (CC BY 3.0)
progress 90% by Roberto Chiaveri from [Noun Project](#) (CC BY 3.0)
website by Larea from [Noun Project](#) (CC BY 3.0)
Download by Melisa Lutfiani from [Noun Project](#) (CC BY 3.0)
Map by Sunrise from [Noun Project](#) (CC BY 3.0)
Time by Arto Moro from [Noun Project](#) (CC BY 3.0)
nassau county by Ary Prasetyo from [Noun Project](#) (CC BY 3.0)
lancaster county by Ary Prasetyo from [Noun Project](#) (CC BY 3.0)
brunswick county by Ary Prasetyo from [Noun Project](#) (CC BY 3.0)
charlotte county by Ary Prasetyo from [Noun Project](#) (CC BY 3.0)
Move by Tomas Knopp from [Noun Project](#) (CC BY 3.0)
Zoom by Serena from [Noun Project](#) (CC BY 3.0)
script by Critical_icon from [Noun Project](#) (CC BY 3.0)
Robot by BEARicons from [Noun Project](#) (CC BY 3.0)
specialist team by Delwar Hossain from [Noun Project](#) (CC BY 3.0)
all other images are by CoreLogic, all rights reserved